

LEVEL 1

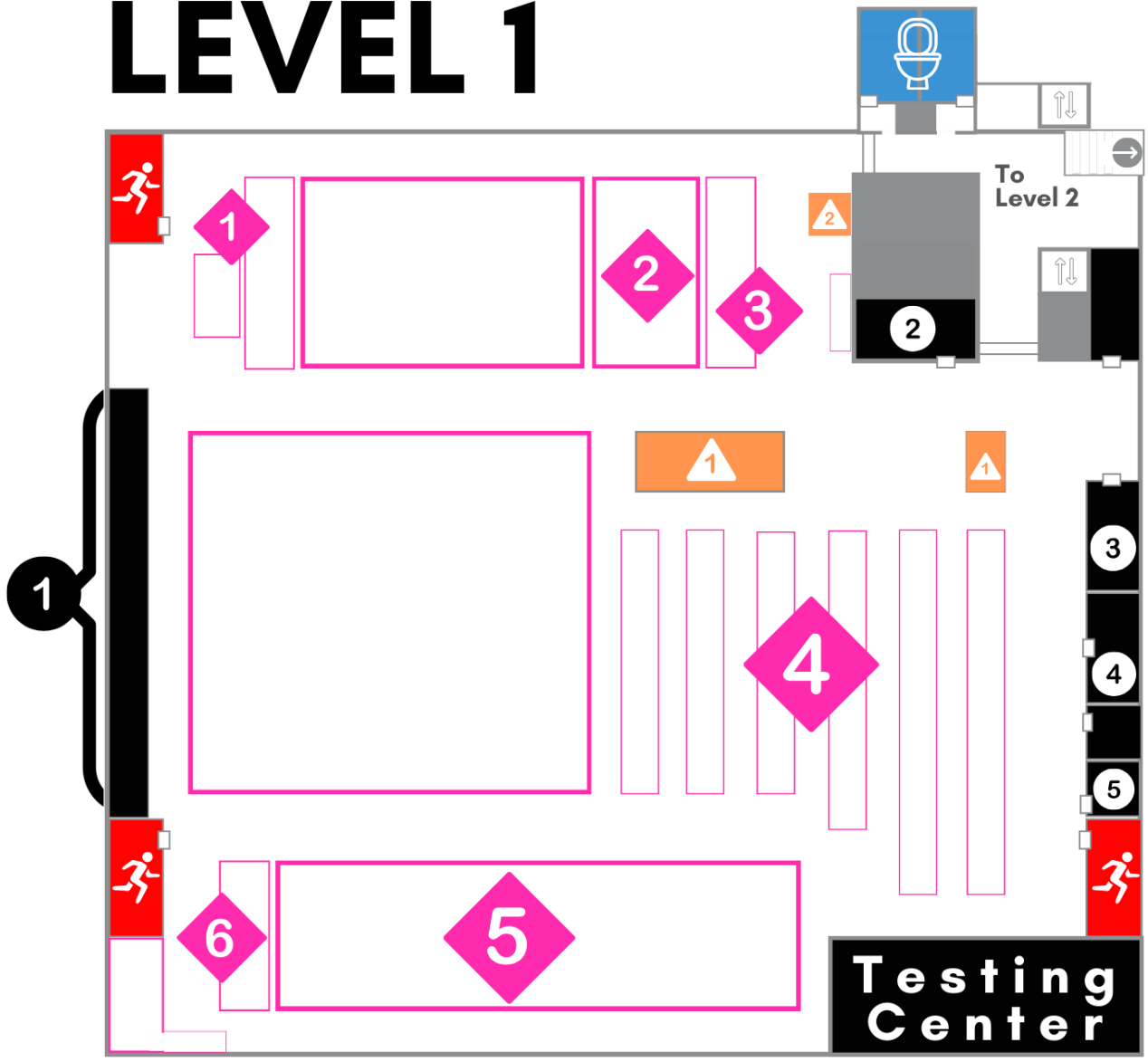

- | | | |
|--|---|-------------------------------------|
| 1 Study Carrels | 1 Newspapers | 5 Compact Shelving Gov. Docs |
| 2 Studio 1 (Rm. 102) | 2 Music Scores | 6 Oversized Section |
| 3 Studio 2 (Rm. 111) | 3 Raoul CDs & CDs | 1 Computers |
| 4 Editing & Data Stations (Rm. 112) | 4 Gov. Docs Microfilm/Microfiche | 2 DVD/VHS/Blu-Ray Player |
| 5 Studio Support Services (Rm. 109) | | |

KEY	Restrooms	Emergency Exit	
Books	Display Cases	Elevators	

LEVEL 2

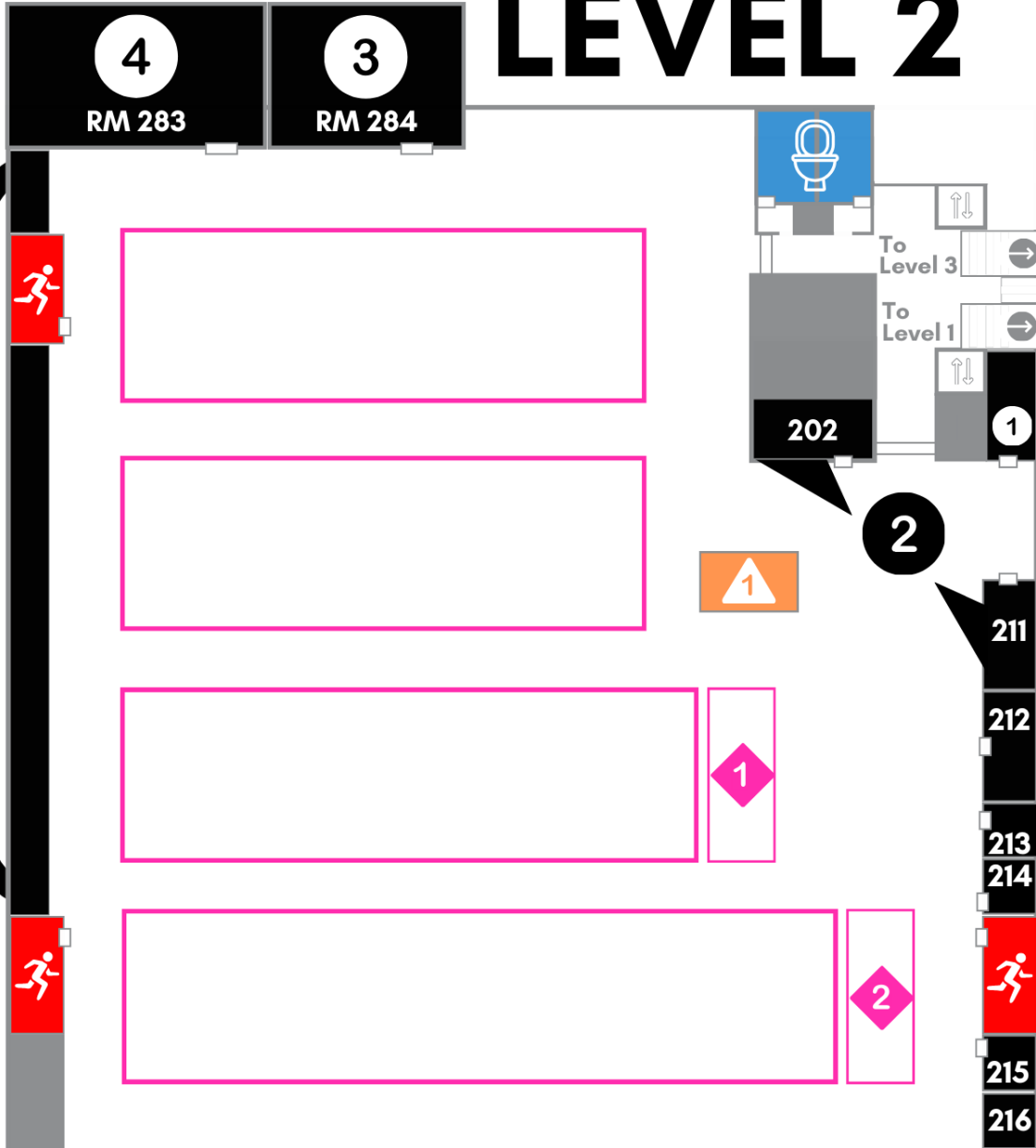

- 1** Accessible Technology Room
- 2** (East side) Reservable Study Rooms
- 1** Children's Collection
- 3** Buckhous Room
- 4** Student Learning Center
- 2** Oversized Section
- 5** Study Carrels
- 1** Computers

KEY	Restrooms	Emergency Exit	
Books	Display Cases	Elevators	Doors

LEVEL 3

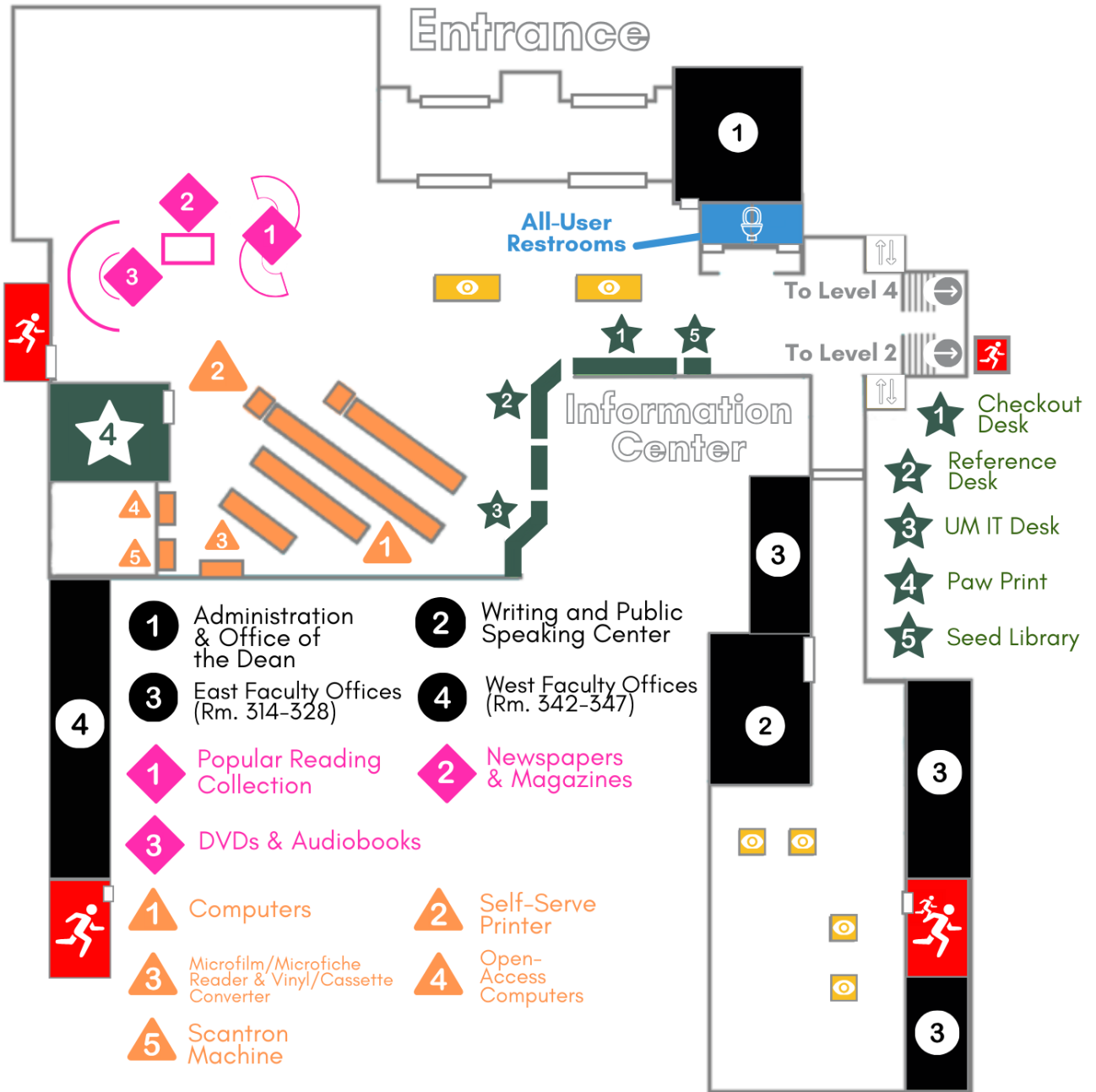

KEY	Restrooms	Emergency Exit	
Books	Display Cases	Elevators	

LEVEL 4

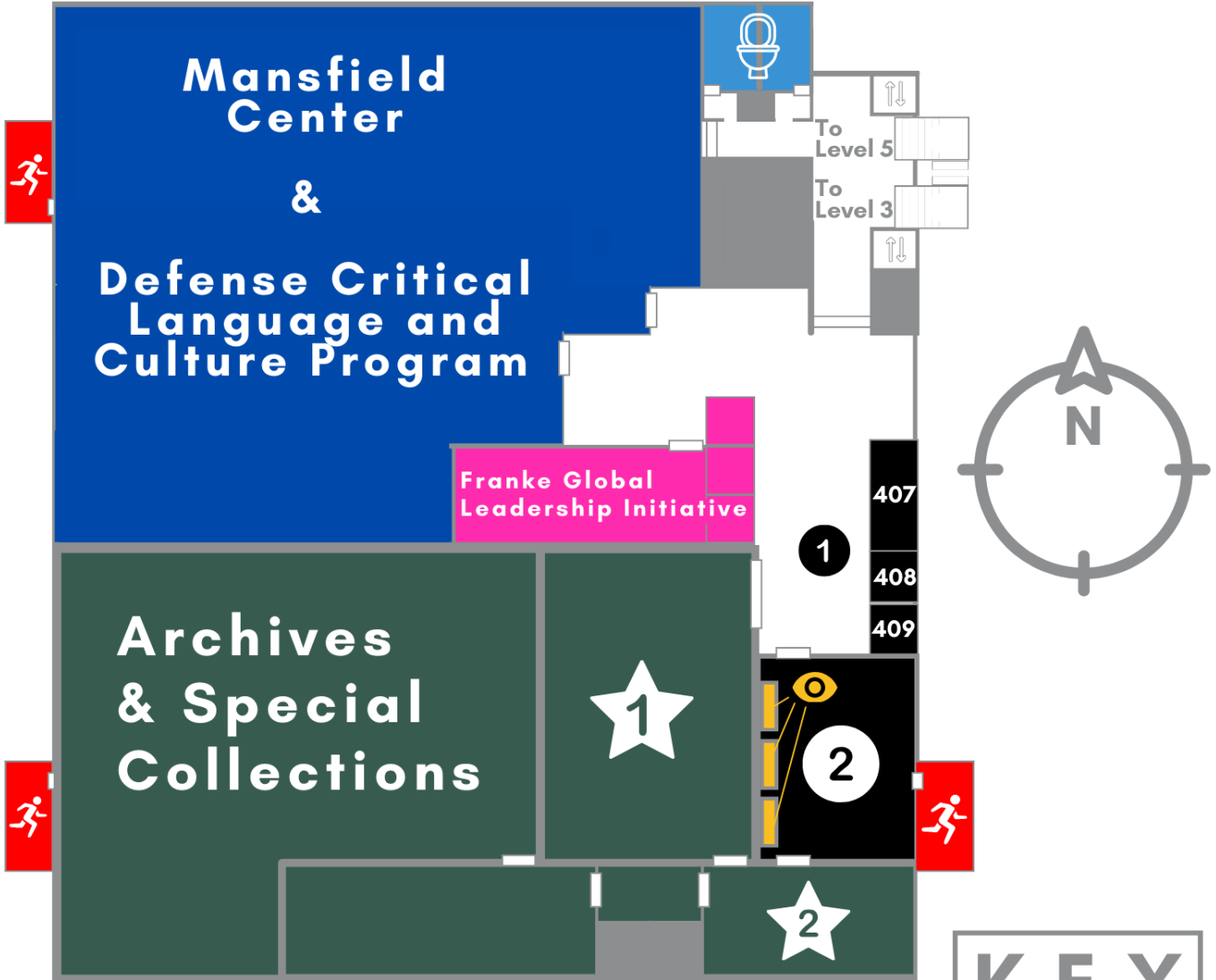







1 Reservable Study Rooms

2 Theta Rho

★ Reading Room and Montana Collection

★ Archives Teaching Room

KEY

-  Restrooms
-  Display Cases
-  Emergency Exit
-  Elevators
-  Books
-  Doors

LEVEL 5

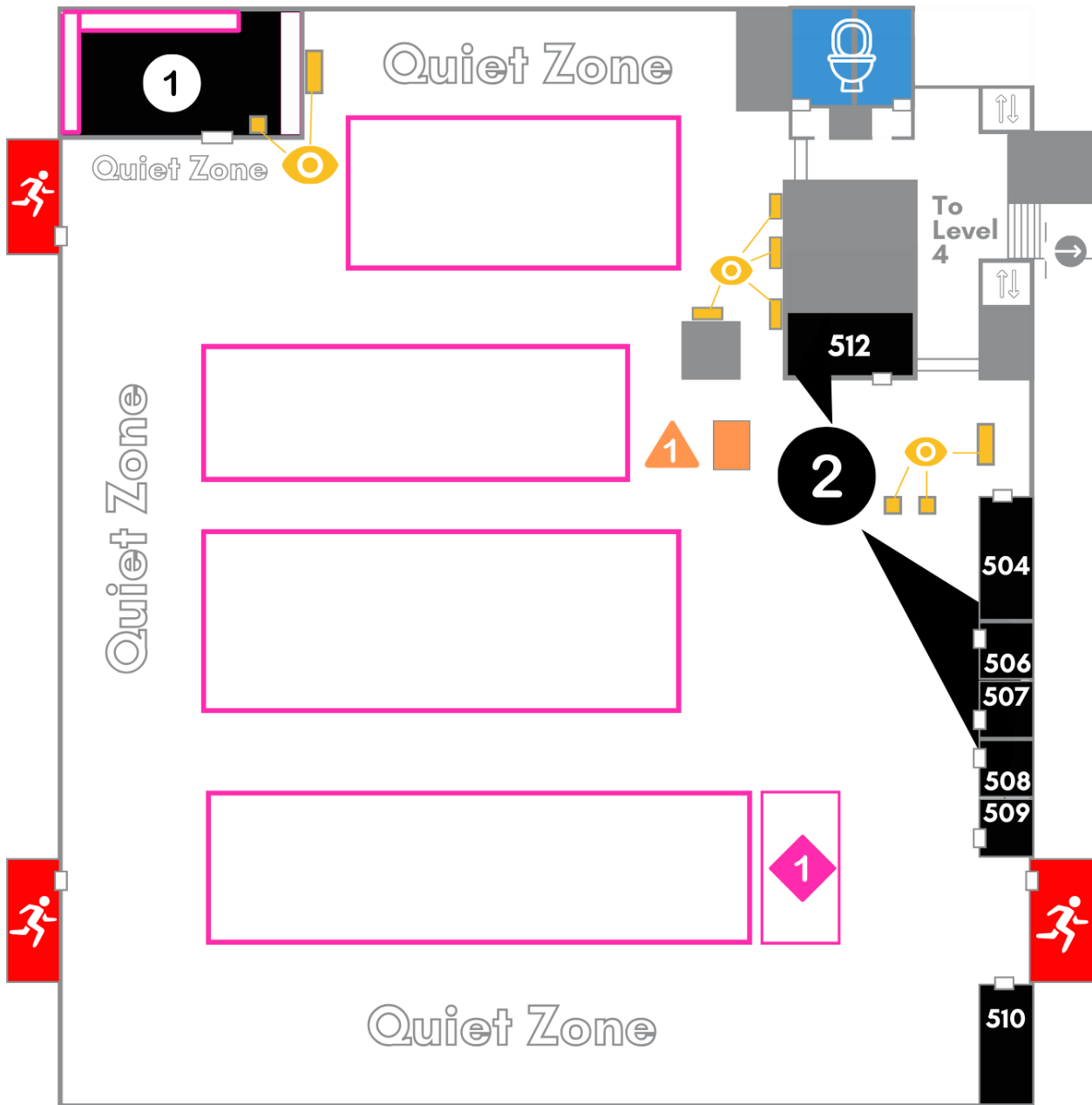

1 Poetry Corner **2** (Numbered Rooms) Reservable Study Rooms

1 Oversized Section **1** Computers

KEY	Restrooms	Emergency Exit	
Books	Display Cases	Elevators	
		Doors	